

Step 1

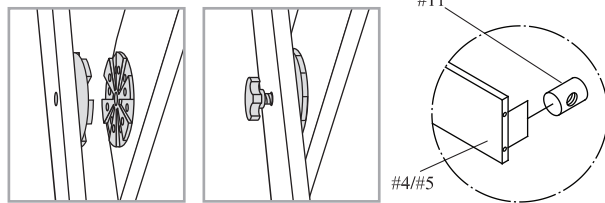

Please ensure that the plastic part on the angled leg and the plastic part of the table frame fit together. Secure the angled leg and table frame together using the Handle Bolt (#10). Repeat this step for the other side of the table.

Step 2

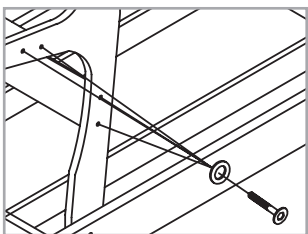

Step 3

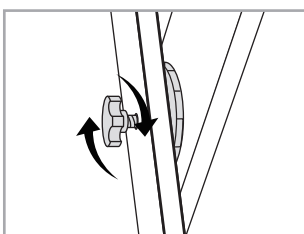

Step 4

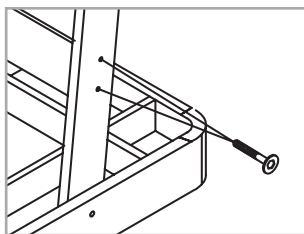

Step 6

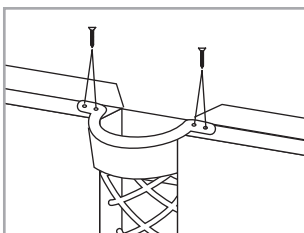

Step 7

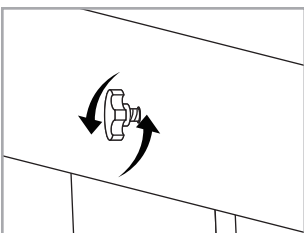

Step 8

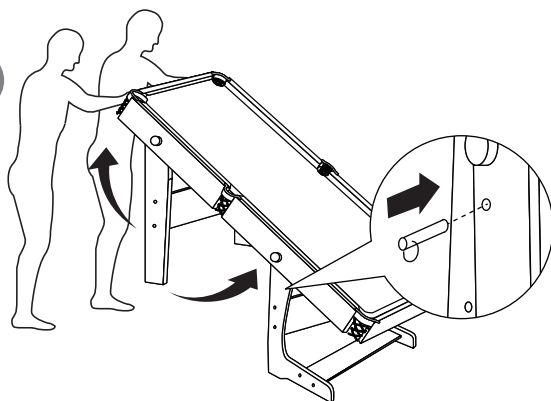

Step 9

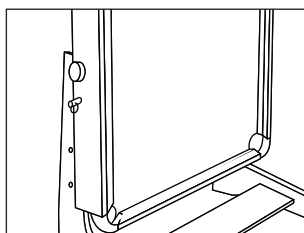

Step 1

With the table face down place the angled leg (#2) inside the table frame. Please ensure that the angled leg is secured at the end of the table with the two pre-drilled holes.

Step 2

Place leg nut (#11) into leg panels (#4 and #5). Using bolt (#8) and washer (#7) fix the lower leg panel (#4) and leg side panels (#5) to the angled legs.

Step 3

At the other end of the table attach the straight legs (#3) inside the table frame. Please ensure that the plastic part on the straight leg and the plastic part of the table frame fit together. Secure the straight leg and table frame together using the Handle Bolt (#10) and washer (#6). Repeat this step for the other side of the table.

Step 4

Place leg nut (#11) into leg side panel (#5). Using bolt (#8) and washer (#7) fix the leg side panel (#5) to the straight legs.

Step 5

Ensure all bolts and screws are firmly tightened and with at least two adults carefully turn the table onto the legs;

Step 6

Using screw (#9) attach the pockets to the table frame.

Step 7

To fold the table please remove all accessories from the playing surface and carefully loosen but not remove the handle bolts on the angled legs.

Step 8

With the handle bolts still attached and with the use of at least two adults carefully raise the table towards its standing position. Once done please insert the safety pins (#12) into the remaining holes between the angled legs and the main table frame.

Step 9

Carefully tighten the handle bolts on the angled legs and loosen the handle bolts on the straight legs so that the legs can be folded against the table.

Step 10

Whenever the table is raised or lowered be sure to use a minimum of two adults to perform this operation. Please ensure that the space around the table is clear and free of obstructions and once the operation is completed please secure all bolts and screws again. Please take care at all times when the table is in the raised position